

What to expect

Everyone's response to Mounjaro is different. Your dose may change if you need additional blood sugar control.

If your doctor has prescribed once-weekly Mounjaro, **you'll start with 2.5 mg**. After 4 weeks, **you'll move on to 5 mg**.*

*Mounjaro should be used once each week.

Start



2.5MG
FOR 4 WEEKS

Continue



5MG
FOR AT LEAST
4 WEEKS

Mounjaro has additional dose options—7.5 mg, 10 mg, 12.5 mg, 15 mg. You and your doctor can find the one that's right for you.

Select Safety Information

Serious allergic reactions. Stop using Mounjaro and get medical help right away if you have any symptoms of a serious allergic reaction, including: swelling of your face, lips, tongue or throat, problems breathing or swallowing, severe rash or itching, fainting or feeling dizzy, and very rapid heartbeat.



Managing side effects

Talk to your doctor if you have any side effect that bothers you or does not go away. Everyone can have a different experience, but these are the most common side effects patients had:

- Nausea
- Diarrhea
- Decreased appetite
- Vomiting
- Constipation
- Indigestion
- Stomach pain

In studies, most nausea, vomiting, and diarrhea events occurred while the dose of Mounjaro was being increased. These events decreased over time.

If you experience nausea, talk to your doctor. In the meantime, some people find the following tips may help:

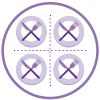

Eat smaller meals



Avoid fat or fatty foods



Stop eating when you feel full



Try eating bland foods like toast, crackers, or rice

Select Safety Information

Kidney problems (kidney failure). In people who have kidney problems, diarrhea, nausea, and vomiting may cause a loss of fluids (dehydration), which may cause kidney problems to get worse. It is important for you to drink fluids to help reduce your chance of dehydration.

Severe stomach problems. Stomach problems, sometimes severe, have been reported with Mounjaro. Tell your healthcare provider if you have stomach problems that are severe or will not go away.

Next up — How to use and store Mounjaro

Please see Select Safety Information throughout the brochure and the Indication and Safety Summary with Warnings about possible thyroid tumors, including thyroid cancer, on pages 14-15. Please see Instructions for Use included with the pen.

once weekly
mounjaro[®]
(tirzepatide) injection 0.5 mL
2.5 mg | 5 mg | 7.5 mg | 10 mg | 12.5 mg | 15 mg

Used once a week

Mounjaro comes in a single-dose pen.

The Mounjaro single-dose pen is activated with the click of a button. Read the **Instructions for Use** included with your pen.

Pick a day. Take Mounjaro on the same day each week. It may help to set a reminder on your phone for this day. If you need to change the day, make sure there are at least 3 days (72 hours) in between doses.

Miss a dose? You can take the dose within 4 days (96 hours) after the missed dose. If more than 4 days have passed, skip the missed dose and take the next dose on the regularly scheduled day.

Do not take 2 doses of Mounjaro within 3 days of each other.



How to use your Mounjaro Pen*

Watch a step-by-step video on using Mounjaro here:
mounjaro.com/how-to-use

*These are not the complete instructions for using Mounjaro. Before starting Mounjaro, your healthcare provider should show you how to use the pen. Read the Instructions for Use included with your pen or watch how to use the Mounjaro Pen at mounjaro.com.

Select Safety Information

Changes in vision. Tell your healthcare provider if you have changes in vision during treatment with Mounjaro.

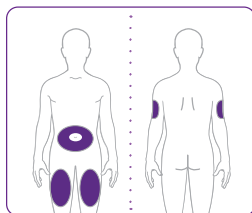

Choose your injection site

- Your healthcare provider can help you choose the injection site that is best for you.
- You or another person can inject the medicine in your stomach or thigh.
- Another person should give you the injection in the back of the upper arm

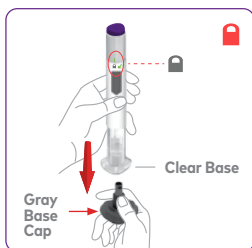

Pull off the gray base cap

- Make sure the pen is **Locked** until it's on your skin and ready to inject.
- **Pull** the gray base cap off and throw it away in the trash.
- **Do not** put the gray base cap back on and do not touch the needle.

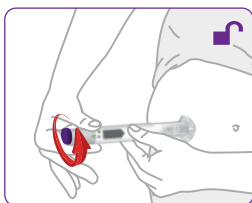

Place on the skin, then Unlock

- **Place** the clear base flat against your skin at the injection site.
- **Unlock** by turning the lock ring.

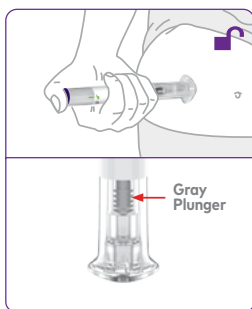

Press and Hold up to 10 seconds

- **Press and Hold** the purple injection button.
- **Listen** for:
1st click = injection started
2nd click = injection completed
- You will know your injection is complete when the gray plunger is visible.
- After your injection, place the used pen in a sharps container.

Next up — How to use and store Mounjaro (cont'd)

Please see Select Safety Information throughout the brochure and the Indication and Safety Summary with Warnings about possible thyroid tumors, including thyroid cancer, on pages 14-15. Please see Instructions for Use included with the pen.

once weekly
mounjaro[®]
(tirzepatide) injection 0.5 mL
2.5 mg | 5 mg | 7.5 mg | 10 mg | 12.5 mg | 15 mg

Safe storage and handling

Storing Mounjaro Pens

- Store the pens in their original carton to protect the pen from light.
- Keep Mounjaro in the refrigerator at 36°F to 46°F (2°C to 8°C).
- **Do not** freeze your Mounjaro Pens.
- The pen has glass parts. Handle it carefully. If you drop the pen on a hard surface, **do not** use it. Use a new pen instead.

If you're traveling or will be away from home, Mounjaro can be kept for up to 21 days outside of the refrigerator. Just make sure the temperature doesn't get higher than 86°F (30°C).

Disposing of Mounjaro Pens*



- Safely dispose of your pens in a sharps container.
- If you don't have a sharps container, you can reuse an empty laundry bottle or a coffee can. Just make sure it:
 - Has a closeable lid
 - Is puncture-resistant
 - Is labeled as hazardous waste

*Keep the container out of reach of children. Do not recycle your used sharps container. Check the regulations in your area for how to dispose of the container properly.

Select Safety Information

Gallbladder problems. Gallbladder problems have happened in some people who use Mounjaro. Tell your healthcare provider right away if you get symptoms of gallbladder problems, which may include pain in your upper stomach (abdomen), fever, yellowing of skin or eyes (jaundice), and clay-colored stools.